

Technical Bulletin	TB234
Product Group	Efel/MF
Edition No:	1
Date	01/2014

## Harmony 5 converted to use Harmony 13 plates and baffle

**Harmony 5 multifuel can be converted to use the Harmony 13 cast iron plates and vermiculite baffle. The plates and baffle can be supplied as a complete kit.**

**Part No: MS2331**

The Harmony 5 multifuel stove has the same size fire box as the Harmony 13 stove. The cast iron side plates, the rear cast plates and the vermiculite baffle from the Harmony 13 can be used to replace all the parts inside the Harmony 5 firebox of both the Mk1 and Mk2 stoves. The grate frame, grate and lower side castings, rear protection plate 32815 and log guard are the same and can be kept. Remove the existing baffle (which can either be steel or cast iron), the two side plates and the lower rear protection plate shown below.

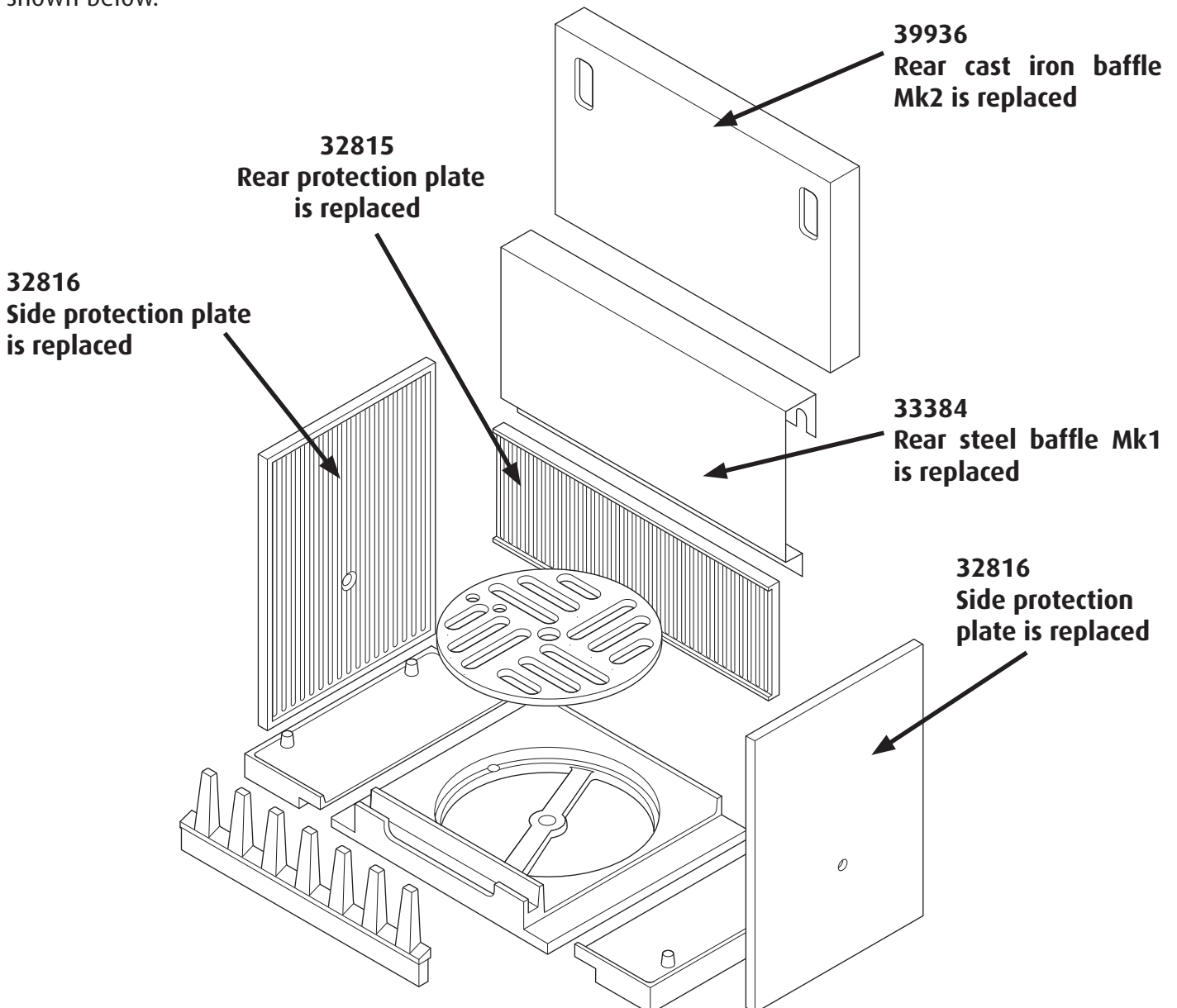

Technical Bulletin	TB234
Product Group	Efel/MF
Edition No:	1
Date	01/2014

## Harmony 5 converted to use Harmony 13 plates and baffle

We would suggest that all the cast iron parts are removed and the firebox cleaned of any ash so that the new cast iron plates will slot in easily. Replace the grate frame, grate and bottom side cheeks after doing this. Firstly put in the rear lower protection plate 32815. Then both side plates, this will hold in place the lower rear plate 32815, which is the one plate retained from the original protection plates.

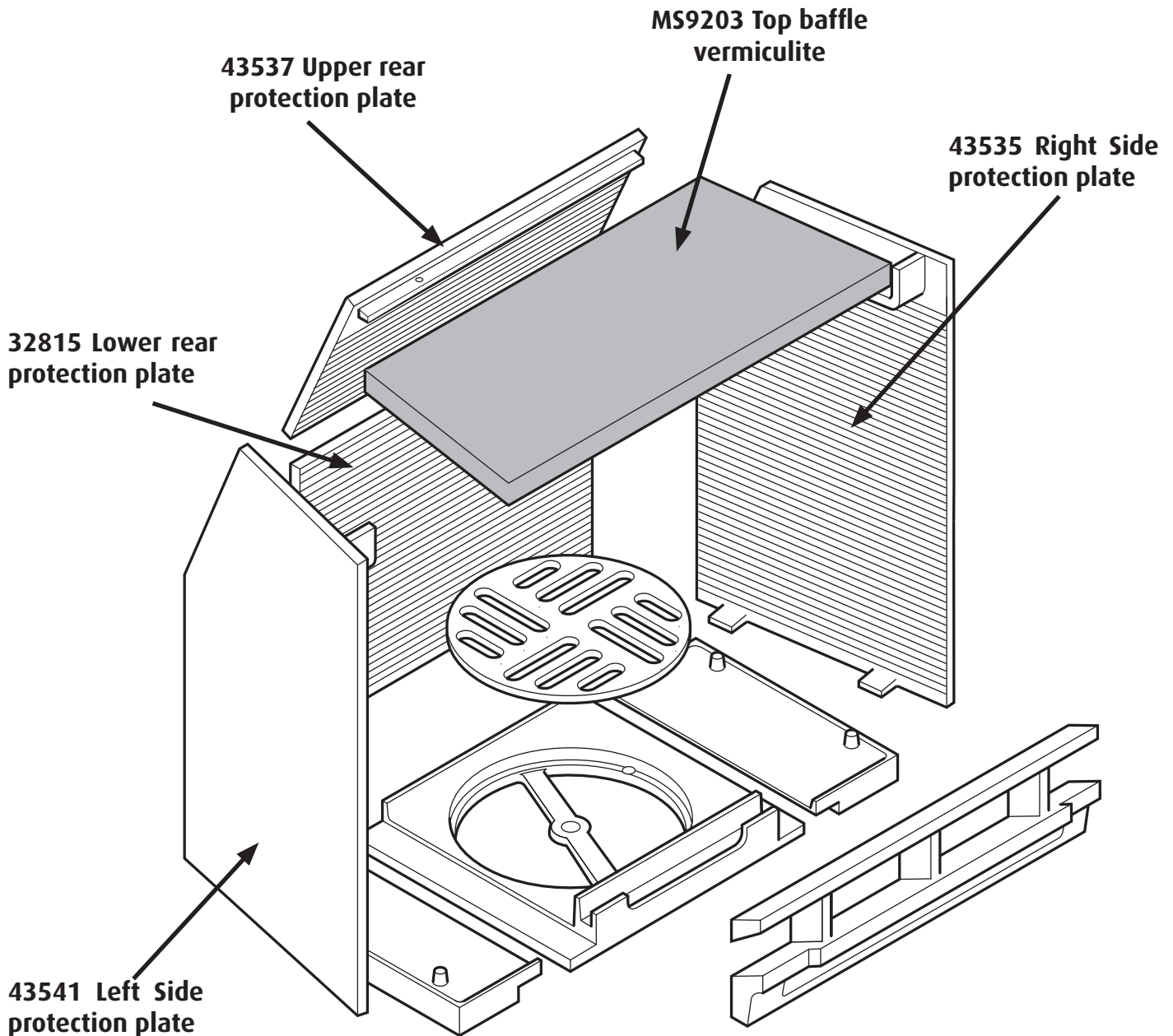

Technical Bulletin	TB234
Product Group	Efel/MF
Edition No:	1
Date	01/2014

## Harmony 5 converted to use Harmony 13 plates and baffle

The upper rear cast iron plate slides down the back of the two side plates to sit on top of the lower rear protection plate. Ensure that there are the two screws in the top of it, as these act as a stop to stop the baffle board from sliding backwards when fitted into the top of the stove.

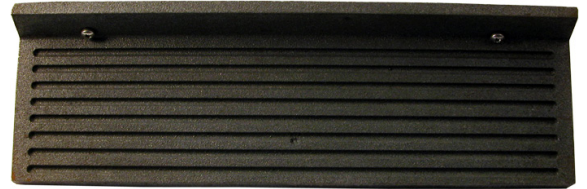

The vermiculite baffle can then be slid up into place ensuring that the baffle sits across the top. The front edge located as far forward in the L shaped cast retainers on the side panels and the rear in front of the two screws on the rear angled plate.

The stove can be operated exactly the same with these new plates fitted as it does not effect the way the air enters the stove. Periodically the top vermiculite baffle should be removed to remove any ash or soots that may have accumulated there. The plates should be removed at the end of the heating season and any ash which has collected behind them removed as part of the summer shut down of the stove.

### Removal of the Top Baffle

The vermiculite top baffle will need removing at regular intervals, dependant upon the stoves use, to remove any soot and debris which may have accumulated on top of it. If this is not done the flue way may become choked and the stove will not operate as efficiently.

The top mica baffle is located in the top of the fire box where it sits on the L shaped baffle support lugs which are part of the casting of the left and right side protection plates. For easier access remove the front fuel guard. To remove (1) lift the front of the baffle board upwards above the height of the locating lugs (2) whilst lifting the front of the board slide it towards the front of the fire box. The rear edge of the baffle does not quite fully pass the front edge of the upper rear protection plate (3). This should be pushed back at the top to allow the rear of the baffle to be dropped down, (4) allowing the baffle to be pulled down into the main body of the fire box. It can then be angled to withdraw it through the door.

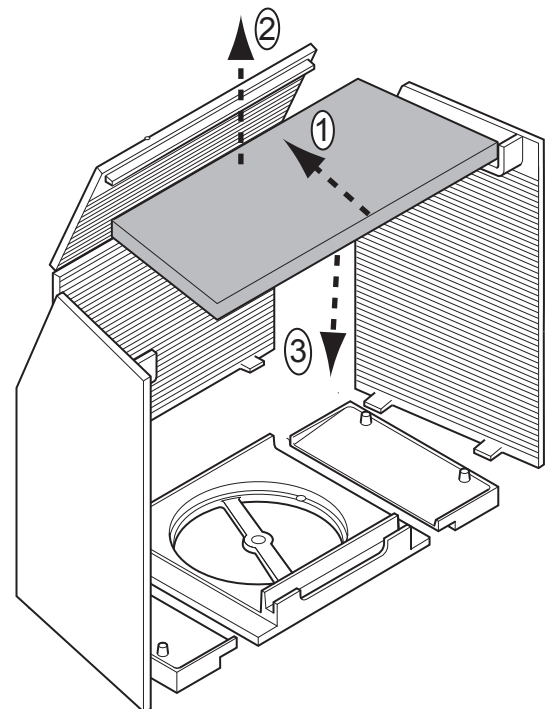

To refit the replacement reverse the procedure.

Technical Bulletin	TB234
Product Group	Efel/MF
Edition No:	1
Date	01/2014

## Harmony 5 converted to use Harmony 13 plates and baffle

### Removal of the Upper Protection Plate

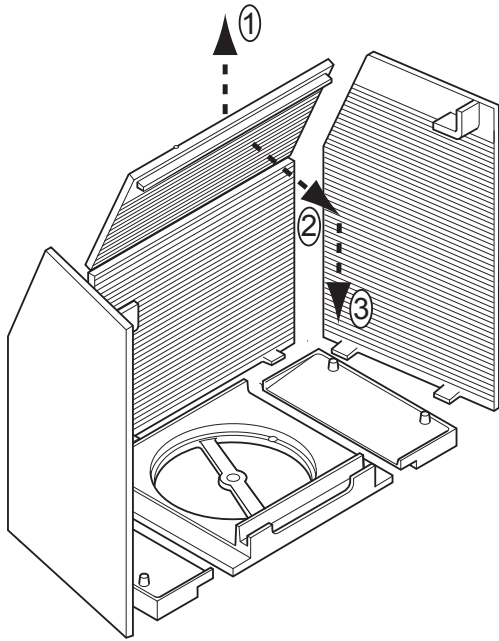

The upper protection plate is held in place by the two side protection plates. To remove (1) lift up the plate and then (2) draw it towards the front of the fire box.

As it is drawn forward (3) pull the front edge downwards so moving it free of the side protection plates. It can then be angled within the fire box to withdraw it through the door.

To refit the replacement reverse the procedure.

### Removal of the Side Protection Plate

To remove (1) lift up the plate so it is higher than the lugs on the lower side protection plates and then (2) draw it towards the centre of the fire box.

As it is drawn towards the centre (3) twist the rear edge towards the front of the fire box. It can then be angled within the fire box to withdraw it through the door.

To refit the replacement reverse the procedure.

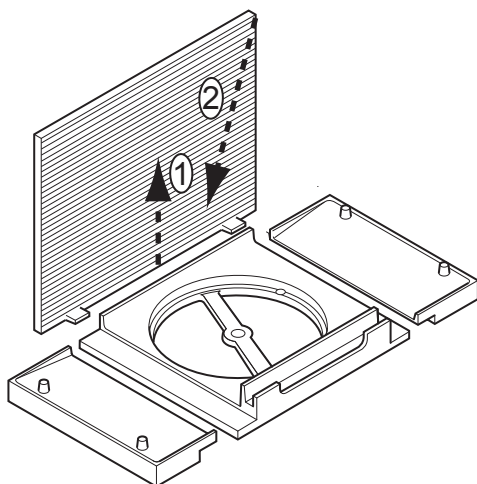
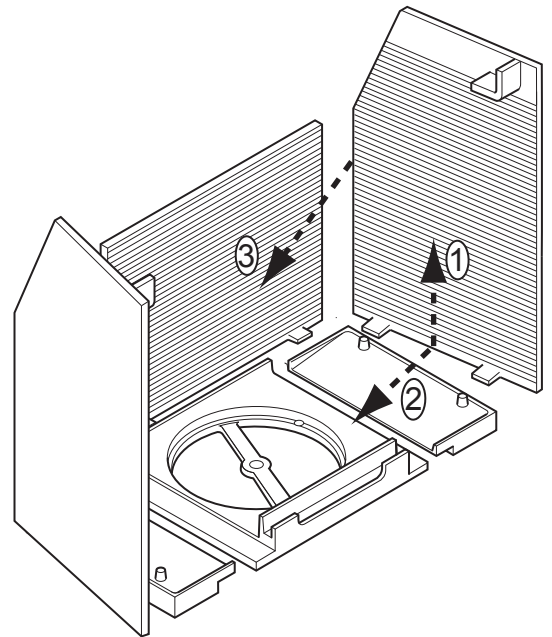

### Removal of the Rear Protection Plate

To remove (1) lift up the plate so it is higher than the lugs on the grate frame and then (2) draw it towards the centre of the fire box. As it is drawn towards the centre twist the edge towards the front of the fire box. It can then be angled within the fire box to withdraw it through the door.

To refit the replacement reverse the procedure.