

VIGILANT COAL STOVE MODEL #1400

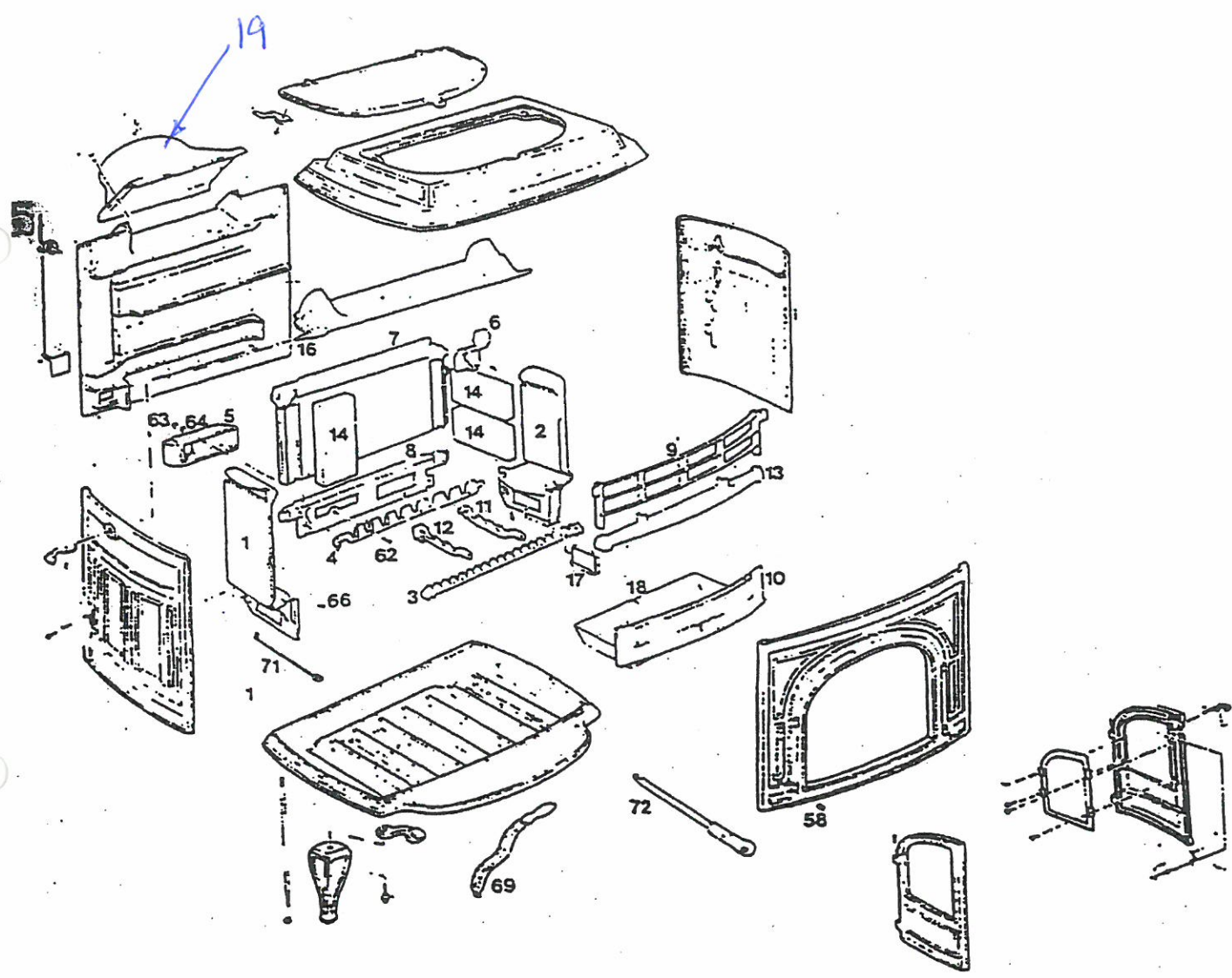

Vigilant Coal Stove

MODEL #'S **1400 VIGILANT COAL**
ALSO CALLED MULTIFUEL STOVE

FEATURES: *MANUFACTURED IN 1982 THROUGH 1992*

DIAGRAM #	ITEM #	PART DESCRIPTION
1	1305000	LEFT SIDE PLATE (INNER)
2	1305004	RIGHT SIDE PLATE (INNER)
3	1305009	FRONT GRATE SUPPORT
4	1305011	REAR GRATE SUPPORT
5	1305015	AIR TUBE
6	1305018	DAMPER RETAINER
7	1305022	UPPER FIREBACK
8	1305025	LOWER FIREBACK
9	1305029	FRONT GRILL
10	1305033	ASH PAN FRONT
11	1305041	HIGH GRATE BAR
12	1305038	LOW GRATE BAR
13	1305047	FETTLE
14	1601103	SPLIT FIREBACK
15	5000992	DAMPER W/PIN
16	1300671	AIR CONTROL
17	1304277	BACK
17	1602202	CLEANOUT COVER
18	1304258	BOTTOM
18	1400928	ASHPAN
19	1304280	FLUE COLLAR 8" OVAL
20	1304273	FRONT
	5000945	FRONT W/ DOORS ASS'Y
21	1300797	GRIDDLE
22	1300809	GRIDDLE QUAD
23	1300515	LATCH PAWL
24	1304224	LEFT DOOR
25	1304269	LEFT END
26	1303225	LEG
27	1304216	RIGHT DOOR
28	1304262	RIGHT END
29	1301935	SHAKER HANDLE SUPPORT

30	1304251	TOP
31	NA	T-STAT FLAP ASS'Y
SUBSTITUTE:	2005410	
32	0004342	CERAMIC HANDLE ASS'Y
33	1601555	T-STAT FLAP WIRE
34	5004265	DAMPER HANDLE ASS'Y
35	5004237	DOOR HANDLE/STUB ASS'Y
36	1600546	DOOR PIN
37	1401119	GLASS PANEL
	1601392	GLASS CLIP (LONG)
	1601391	GLASS CLIP (SHORT)
38	0004320	THERMOSTAT ASS'Y
	1201846	THERMOSTAT SPRING
39	1601487	THERMOSTAT COVER
58	1201903	BUSHING
69	1600903	SHAKER HANDLE
71	1600904	SHAKER ROD (11 1/2")
72	5005708	SLICER/POKER ASS'Y
73	NA	LEG BOLT PKG
SUBSTITUTE:	(4) 1201443	
74	1600600	DOOR HANDLE HOLDER
	1601629	TIE ROD
	5007498	SET OF 4 TIE RODS & HARDWARE
	1205116	ALLEN WRENCH 1/8"
	1205147	ALLEN WRENCH 5/32"
	1601705	MITTENROD

ENAMEL PARTS

*** PREFIX FOR ENAMEL PARTS**

131 RED	136 GRAY
132 SAND	137 CHOCOLATE BROWN
133 BLUE	138 ANTIQUE GREEN
134 MIDNIGHT	

* 0671	AIR CONTROL (N/A IN RED. SUBSTITUTE: CLASSIC BLACK ONLY)
* 3225	LEG
* 4216	RIGHT DOOR (N/A IN SAND, BLUE, MIDNIGHT, ANTIQUE BROWN; SUB. CLASSIC BLACK ONLY)
* 4224	LEFT DOOR (N/A IN SAND, BLUE, MIDNIGHT, ANTIQUE BROWN; SUB. CLASSIC BLACK ONLY)
* 4251	TOP (N/A IN SAND, BLUE, MIDNIGHT, ANTIQUE BROWN; SUB. CLASSIC BLACK ONLY)
* 4258	BOTTOM (N/A IN SAND, BLUE, MIDNIGHT, ANTIQUE BROWN. SUB. CLASSIC BLACK)

- * 4262 RIGHT END (N/A IN SAND, BLUE, MIDNIGHT, ANTIQUE BROWN. SUB. CLASSIC BLACK)
- * 4269 LEFT END (N/A IN SAND, BLUE, MIDNIGHT, ANTIQUE BROWN. SUB. CLASSIC BLACK)
- * 4273 FRONT (N/A IN SAND, BLUE, MIDNIGHT, ANTIQUE BROWN. SUB. CLASSIC BLACK)
- * 4277 BACK (N/A IN RED, SAND, BLUE, MIDNIGHT, ANTIQUE BROWN. SUB. CLASSIC BLACK)
- * 4280 FLUE COLLAR (N/A IN ANTIQUE BROWN)
- 5006482 SET OF 4 LEGS - RED
- 5006485 SET OF 4 LEGS - SAND
- 5006496 SET OF 4 LEGS - BLUE

HARDWARE

- 1201322 10 - 24 X 1/2 HEX HEAD CAP SCREW
(BOTTOM HEAT SHIELD FASTENERS)
- 1201152 3/8 - 16 X 1/2 SL RD HD
(4 LEG BOLT HOLES)
- 1202446 17/64 X 7/8 X .05 PL FL WASHER
(PRIMARY AIR TUBE)
- 1200993 1/4 - 20 X 3/8 PH PAN HD
(SHAKER HANDLE HOLDER)
- 1202470 1/4 PLAIN FL WASHER
(3-ASHDROP TO BOTTOM, 2-HINGE TO BOTTOM)
- 1201374 1/4 - 20 X 3/4 HEX HD CS
(3- ASHDROP TO BOTTOM)
- 1202474 1/4 FLAT WASHER
(SHAKER HANDLE SUPPORT)
- 1201372 1/4 - 20 X 5/8 HEX HD CS
(2-HINGE TO BOTTOM)
- 1202473 1/4 FL WASHER
(2-ASHPAN BRACKET)
- 1201374 1/4 - 20 X 3/4 HEX HD CAP SCREW
(DAMPER RETAINER)
- 1200896 1/4 - 20 X 5/8 PH RD HD
(INNER SIDE PLATES)

- 1203213 1/4 - 20 FLEX LOCK HD NUT
(TIE ROD)
- 1201443 3/8 - 16 X 1 1/4 FUL THD HEX HD CS
(LEG BOLTS)
- 1202488 3/8 WASHER
(LEG)
- 1201745 1/4 - 20 X 1 HEX HEAD LEVELER BOLT
(LEG LEVELER)
- 1202058 #10 X 1/2 PH PAN SMS
(STOVE PIPE)
- 1200983 10 - 24 X 3/8 PH PAN HD
(GLASS CLIP SCREWS)
- 1200998 10 - 24 X 1/2 PH TR SCREW
(THERMOSTAT COVER SCREW)
- 1200563 DAMPER HANDLE SET SCREW
- 1200436 STRIKER BOLT (PAWL ASSEMBLY)
- 1203210 STRIKER BOLT NUT (PAWL ASSEMBLY)
- 1200417 SET SCREW (PAWL ASSEMBLY)
- 1203290 LARGE PAWL NUT (PAWL ASSEMBLY)
- 1201832 HANDLE ROLL PIN (PAWL ASSEMBLY)
- 1203329 DAMPER RETAINER NUT (1/4 - 20 SQ)
- 1200848 1/4 - 20 X 2 PH FL HD
(PRIMARY AIRTUBE)
- 1203229 1/4 - 20 SQ NUT
(AIRHORN)
- 1201338 1/4 - 20 X 1/2 HEX HD CP
(QUAD SCREW. 2 - ASHPAN BRACKET)

- 1200998 10 - 24 X 1/2 PH TRUSS HD
(HEAT SHIELD HOLE SCREWS)
- 1200830 1/4 - 20 X 3/4 PH FL HD
(PRIMARY AIRTUBE)
- 1200907 1/4 - 20 X 1 PH RD HD
(FLUE COLLAR SCREW)
- 1200555 BUSHING PLUG
- 1201007 1 - 24 X 3/4 TRS HD PH
(SECONDARY AIR COVER SCREW)
- 1201903 SHAKER HOLE JAM BUSHING 1/3"
- 1201904 OVERSIZED SHAKER HOLE BUSHING 5/8"

GASKETS

BELOW IS LISTED THE TYPE OF GASKET AND THE LENGTH NEEDED ON THE VIGILANT COAL.

LOCATION	GASKET SIZE	NEEDED	NUMBER
FRONT DOORS	5/16" FIBERGLASS/6 NDLE MED DENS	5.9'	1203588
GLASS GASKET	3/16" FIBERGLASS	5'	1203556
GRIDDLE	5/16" ARMASEAL	4'	1203668
FLUE COLLAR	5/16" ADHESIVE BACKED FIBERGLASS	2'	1203591
ASH DOOR	3/8" FIBERGLASS	4'	1203589