

PART NUMBER DISCRIPTION

1	B70011789	BOSKY	F25/F30	STANDARD TOP HOTPLATE COMPLETE
2	B70012379	BOSKY 25/30	F25/F30	SMALL CENTRE HOTPLATE STANDARD
3	B70012956	BOSKY	F25/F30	VITRIFIED TOP HOT PLATE COMPLETE
4	B70011792	BOSKY 25/30	F25/F30	LARGE CENTRE ROUND HOT PLATE STANDARD
5	B70012958	BOSKY 25/30	F25/F30	LARGE CENTRE ROUND HOT PLATE VITRIFIED
6	B70012964	BOSKY 25/30	F25/F30	SMALL CENTRE ROUND HOT PLATE VITRIFIED
7	B70012958	BOSKY 25/30	F25/F30	LARGE CENTRE ROUND HOT PLATE VITRIFIED
8	B70011792	BOSKY 25/30	F25/F30	LARGE CENTRE ROUND HOT PLATE STANDARD
9	B70008074	BOSKY 25/30	F25/F30	STEEL FLUE COLLER COMPLETE
10	B80011632	BOSKY 25/30	F25/F30	CAST IRON FLUE COLLER
11	B70011792	BOSKY 25/30	F25/F30	LARGE CENTRE ROUND HOT PLATE STANDARD
12	B70011789	BOSKY	F25/F30	HOT PLATE
13	B60011568	BOSKY	F25/F30	BACK TRIM
14	B60011567	BOSKY	'F25/F30	BACK METAL TRIM H338
15	B60004209	BOSKY 25/30	F25/F30	CLEANING TOOL SCRAPER 60/65/90/95/F25/F30/25/30
16	B60004208	BOSKY 25/30	F25/F30	HOTPLATE LIFTING TOOL
17	B70012757	BOSKY	F25/F30	CAST IRON TOP PLATE COMPLETE WITH TOWEL RAILS
18	B80011612	BOSKY 25/30	F25/F30	CAST IRON TOP LEFT SIDE CASTING
19	B80011615	BOSKY	F25/F30	CAST IRON TOP BACK CASTING
20	B60005449	BOSKY 25/30	F25/F30	12MM HOT PLATE ROPE SEAL
21	B80011613	BOSKY	F25/F30	CAST IRON FRONT TOP CASTING
22	B80011614	BOSKY 25/30	F25/F30	CAST IRON TOP RIGHT SIDE CASTING
23	B70012482	BOSKY	F25/F30	CAST IRON COMPLETE TOP PLATE
24	B60011566	BOSKY 25/30	F25/F30	SIDE TOWL RAIL
25	B70011960	BOSKY	F25/F30	TOP PLINTH IN WHITE
26	B70011961	BOSKY	F25/F30	TOP PLINTH IN GUNMETAL
27	B70011963	BOSKY	F25/530	TOP PLINTH IN CARMEL
28	B70011962	BOSKY	F25/530	TOP PLINTH IN BEIGE
29	B70011964	BOSKY	F25/F30	TOP PLINTH IN RED
30	B70011839	BOSKY 25/30	F25/530	RIGHT SIDE PANEL IN WHITE
31	B70011877	BOSKY 25/30	F25/F30	RIGHT SIDE PANEL IN GUNMETAL
32	B70011878	BOSKY 25/30	F25/F30	RIGHT SIDE PANEL IN CARMEL
33	B70011879	BOSKY 25/30	F25/F30	RIGHT SIDE PANEL IN BEIGE
34	B70011880	BOSKY 25/30	F25/F30	RIGHT SIDE PANEL IN RED
35	B70011840	BOSKY 25/30	F25/F30	LEFT SIDE PANEL IN WHITE
36	B70011881	BOSKY 25/30	F25/F30	LEFT SIDE PANEL IN GUNMETAL
37	B70011882	BOSKY 25/30	F25/F30	LEFT SIDE PANEL IN CARMEL
38	B70011883	BOSKY 25/30	F25/F30	LEFT SIDE PANEL IN BEIGE
39	B70011884	BOSKY 25/30	F25/F30	LEFT SIDE PANEL IN RED
40	B70013098	BOSKY 25/30	F25/F30	ELECTRICAL ACCESS COVER IN BEIGE
41	B70013095	BOSKY 25/30	F25/F30	ELECTRICAL ACCESS COVER IN WHITE
42	B70013096	BOSKY 25/30	F25/F30	ELECTRICAL ACCESS COVER IN GUNMETAL
43	B70013097	BOSKY 25/30	F25/F30	ELECTRICAL ACCESS COVER IN CARMEL
44	B70013099	BOSKY 25/30	F25/F30	ELECTRICAL ACCESS COVER IN RED
45	B60011569	BOSKY 25/30	F25/F30	LEFT & RIGHT DOOR HINGE CATCH
46	B60011569	BOSKY 25/30	F25/F30	LEFT & RIGHT DOOR HINGE CATCH
47	B70011583	BOSKY	F25/F30	THERMOSTAT FILE POCKET 1/2 15 X 16L = 200 TOTAL

48	B60011548	BOSKY	F25/F30	ASHPIT LEFT DOOR HINGE
49	B60011549	BOSKY 25/30	F25/F30	BOSKY DOOR HANDLES COMPLETE
50	B60010170	BOSKY	F25/F30	BOSKY MAIN OVEN HINGE
51	B60011552	BOSKY	F30/F25	OUTER OVEN GLASS
52	B60011553	BOSKY	F30/F25	INNER OVEN GLASS
53	B60009950	BOSKY 25/30	F25/F30	BEHIND OVEN DOOR GLASS THERMOMETER
54	B70011803	BOSKY	F25/F30	MAIN OVEN DOOR COMP IN WHITE
55	B70011869	BOSKY	F25/F30	MAIN OVEN DOOR COMP IN GUNMETAL
56	B70011870	BOSKY	F25/F30	MAIN OVEN DOOR COMP IN CARAMEL
57	B70011871	BOSKY	F25/F30	MAIN OVEN DOOR COMP IN BEIGE
58	B70011872	BOSKY	F25/F30	MAIN OVEN DOOR COMP IN RED
59	B70011804	BOSKY	F25/F30	NOT SOLD SEPERATLY SEE COMP OVEN DOOR ABOVE
60	B70011873	BOSKY	F25/F30	NOT SOLD SEPERATLY SEE COMP OVEN DOOR ABOVE
61	B70011874	BOSKY	F25/F30	NOT SOLD SEPERATLY SEE COMP OVEN DOOR ABOVE
62	B70011875	BOSKY	F25/F30	NOT SOLD SEPERATLY SEE COMP OVEN DOOR ABOVE
63	B70011876	BOSKY	F25/F30	NOT SOLD SEPERATLY SEE COMP OVEN DOOR ABOVE
64	B70011801	BOSKY	F25/F30	LOWER OVEN DOOR COMP IN WHITE
65	B70011865	BOSKY	F25/F30	LOWER OVEN DOOR COMP IN GUNMETAL
66	B70011866	BOSKY	F25/F30	OVEN DOOR COMP TWO TONED CARAMEL N/A
67	B70013333	BOSKY	F25/F30	LOWER OVEN DOOR COMP IN CARAMEL
68	B70011867	BOSKY	F25/F30	OVEN DOOR COMP TWO TONED IN BEIGE N/A
69	B70013334	BOSKY	F25/F30	LOWER OVEN DOOR COMP IN BEIGE
70	B70011868	BOSKY	F25/F30	LOWER OVEN DOOR COMP IN RED
71	B70011802	BOSKY	F25/F30	NOT SOLD SEPERATLY SEE COMP OVEN DOOR ABOVE
72	B70011861	BOSKY	F25/F30	NOT SOLD SEPERATLY SEE COMP OVEN DOOR ABOVE
73	B70011862	BOSKY	F25/F30	NOT SOLD SEPERATLY SEE COMP OVEN DOOR ABOVE
74	B70013329	BOSKY	F25/F30	NOT SOLD SEPERATLY SEE COMP OVEN DOOR ABOVE
75	B70011863	BOSKY	F25/F30	NOT SOLD SEPERATLY SEE COMP OVEN DOOR ABOVE
76	B70013330	BOSKY	F25/F30	NOT SOLD SEPERATLY SEE COMP OVEN DOOR ABOVE
77	B70011864	BOSKY	F25/F30	NOT SOLD SEPERATLY SEE COMP OVEN DOOR ABOVE
78	B70011799	BOSKY	F25/F30	LOADING DOOR COMP IN WHITE
79	B70011857	BOSKY	F25/F30	LOADING DOOR COMP IN GUNMETAL
80	B70011858	BOSKY	F25/F30	LOADING DOOR COMP TWO TONED CARAMEL N/A
81	B70013331	BOSKY	F25/F30	LOADING DOOR COMP IN CARAMEL
82	B70011859	BOSKY	F25/F30	LOADING DOOR COMP IN BEIGE
83	B70013332	BOSKY	F25/F30	LOADING DOOR COMP TWO TONED BEIGE N/A
84	B70011860	BOSKY	F25/F30	LOADING DOOR COMP IN RED
85	B70011800	BOSKY	F25/F30	NOT SOLD SEPERATLY SEE COMP OVEN DOOR ABOVE
86	B70011853	BOSKY	F25/F30	NOT SOLD SEPERATLY SEE COMP OVEN DOOR ABOVE
87	B70011854	BOSKY	F25/F30	NOT SOLD SEPERATLY SEE COMP OVEN DOOR ABOVE
88	B70013327	BOSKY	F25/F30	NOT SOLD SEPERATLY SEE COMP OVEN DOOR ABOVE
89	B70011855	BOSKY	F25/F30	NOT SOLD SEPERATLY SEE COMP OVEN DOOR ABOVE
90	B70013328	BOSKY	F25/F30	NOT SOLD SEPERATLY SEE COMP OVEN DOOR ABOVE
91	B70011856	BOSKY	F25/F30	NOT SOLD SEPERATLY SEE COMP OVEN DOOR ABOVE

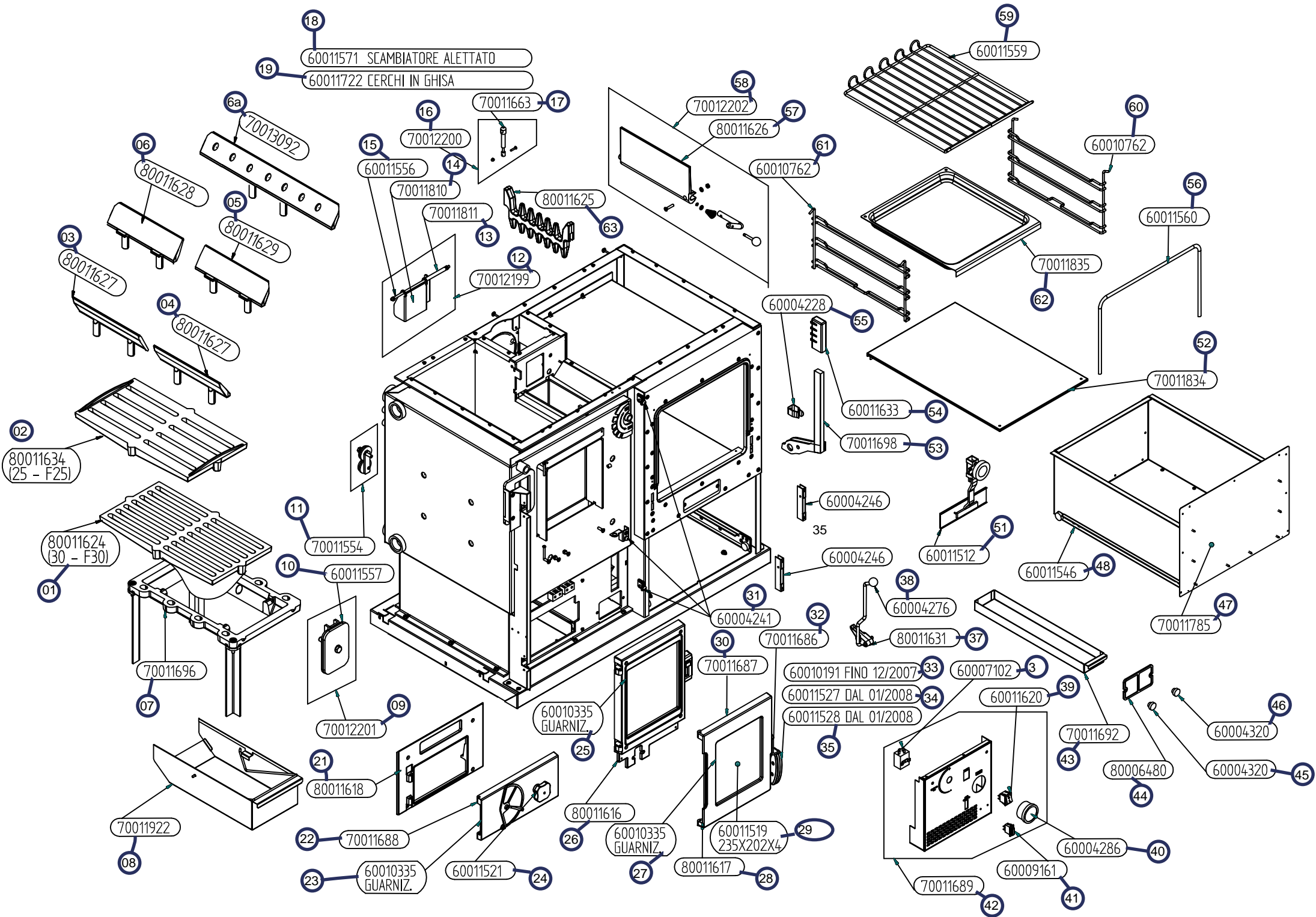

PART NUMBER	DISCRIPTION			
1	B80011624	BOSKY 25/30	F25/F30	BOSKY GRATE
2	B80011634	BOSKY 25/30	F25/F30	BOSKY GRATE
3	B80011627	BOSKY 25/30	F25/F30	LEFTAND BACK RIGHT SIDE CHEEKS
4	B80011628	BOSKY 25/30	F25/F30	RIGHT HAND BACK SIDE CHEEK
5	B80011629	BOSKY 25/30	F25/F30	RIGHT HAND FRONK SIDE CHEEK
6	B80011628	BOSKY 25/30	F25/F30	N/A RIGHT BACK SIDE CHEEK SEE BELOW
6A	B70013092	BOSKY 25/30	F25/F30	STEELCLEANING SIDE WOOD CHEEK WITH HOLES
7	B70011696	BOSKY 25/30	F25/F30	GRADLE
8	B70011922	BOSKY 25/30	F25/F30	ASHPAN
9	B70012201	BOSKY 25/30	F25/F30	BOILER BLANKING PLATE RE EXCHANGER
10	B60011557	BOSKY 25/30	F25/F30	BOILER BLANKING PLATE GASKET
11	B70011554	BOSKY25/30	F25/F30	CLOSING KIT PLUGS
12	B70012199	BOSKY 25/30	F25/F30	DIRECT DRAFT FLAP ASSEMBLY
13	B70011811	BOSKY 25/30	F25/F30	DIRECT DRAFT FLAPSPINDLE SLEEVE
14	B70011810	BOSKY 25/30	'F25/F30	DIRECT DRAFT FLAP ONLY
15	B60011556	BOSKY 25/30	F25/F30	DIRECT DRAFT FLAP SPINDLE
16	B70012200	BOSKY 25/30	F25/F30	DIRECT DRAFT LIFTING ROD COMPLETE
17	B70011663	BOSKY 25/30	F25/F30	DIRECT DRAFT LIFTING ROD ONLY
18	B60011571	BOSKY 25/30	F25/F30	HEAT EXCHANGER
19	B60011722	BOSKY 25/30	F25/F30	SERIESOF HOOPS IN CAST IRON
20	B80011625	BOSKY 25/30	F25/F30	COMB GRATE
21	B80011618	BOSKY 25/30	F25/F30	ASHPIT DOOR FRAME
22	B70011688	BOSKY 25/30	F25/F30	ASHPIT DOOR
23	B60010335	BOSKY 25/30	F25/F30	ASHPIT ROPE 33" X 6MM INC GLUE
24	B60011521	BOSKY 25/30	F25/F30	ASHPIT DOOR KNOB
25	B60010335	BOSKY 25/30	F25/F30	LOADING DOOR FRAME ROPE
26	B80011616	BOSKY 25/30	F25/F30	LOADING DOOR FRAME
27	B60010335	BOSKY 25/30	F25/530	LOADING DOOR ROPE
3	B80011617	BOSKY 25/30	F25/530	LOADING DOOR
29	B60011519	BOSKY 25/30	F25/F30	LOADING DOOR GLASS(336 X 338 X 4MM)
30	B70011687	BOSKY 25/30	F25/530	LOADING DOOR COMPLETE
31	B60004241	BOSKY 25/30	F25/F30	BOILER AND OVEN DOOR BRACKETS
32	B70011686	BOSKY 25/30	F25/F30	HANDLE INNER METAL PART ONLY
33	B60010191	BOSKY 25/30	F25/F30	LEFT& RIGHT PLASTIC HANDLE PART
34	B60011527	BOSKY 25/30	F25/F30	BLACK FRONT COVER HANDLE 01/2008
35	B60011528	BOSKY 25/30	F25/F30	BLACK BACK COVER HANDLE 01/2008
36	B60007102	BOSKY	F25/F30	ANTI CONDENSATION STAT
37	B80011631	BOSKY 25/30	F25/F30	RELEASELEVERASSEMBLY WITHOUT KNOB
38	B6004276	BOSKY 25/30	F25/F30	RELEASELEVER KNOB
39	B60011620	BOSKY	F25/F30	ON/OFF SWITCH
40	B60004286	BOSKY 25/30	F25/F30	BOILER THERMOMETER ROUND
41	B60009161	BOSKY	F25/F30	INDICATER LIGHT
42	B70011689	BOSKY	F25/F30	CONTROL PANEL COMPLETE
43	B70011692	BOSKY 25/30	F25/F30	BOILER CLEAN OUT PAN
44	B80006480	BOSKY 25/30	F25/F30	BOILER CLEANING PLATE
45	B60004320	BOSKY 25/30	F25/F30	BOILER CLEANING PLATE LEFT FASTENERS
46	B60004320	BOSKY 25/30	F25/F30	BOILER CLEANING PLATE RIGHT FASTENERS

47	B70011785	BOSKY	F25/F30	WARMING AND UTENSILL DRAW
48	B60011546	BOSKY	F25/F30	WARMING AND UTENSILL DRAW RAIL
49	B60004246	BOSKY 25/30	F25/F30	LEFT MAIN OVEN DOOR HINGE CATCH
50	B60004246	BOSKY 25/30	F25/F30	RIGHT MAIN OVEN DOOR HINGE CATCH
51	B60011512	BOSKY 25/30	F30/F25	BOILER THERMOSTAT MECH
52	B70011834	BOSKY	F30/F25	BOTTOM OVEN TRAY
53	B70011698	BOSKY 25/30	F25/F30	GRATE SHIFT LEAVER
54	B60011633	BOSKY 25/30	F25/F30	GRATE SHIFT LEAVER HANDLE
55	B6004228	BOSKY 25/30	F25/F30	GRATE SHIFT LEAVER BRACKET
56	B60011560	BOSKY	F25/F30	WARMING DRAW SEAL
57	B80011626	BOSKY	F25/F30	COOKING HEATING FLAP
58	B70012202	BOSKY	F25/F30	COOKING HEATING FLAP COMPLETE
59	B60011559	BOSKY	F25/F30	OVEN WIRE RACK
60	B60010762	BOSKY	F25/F30	LEFT HAND OVEN WIRE RACK HOLDER
61	B60010762	BOSKY	F25/F30	RIGHT HAND OVEN WIRE RACK HOLDER
62	B70011835	BOSKY	F25/F30	BAKING TRAY